

Taper Locking Assemblies

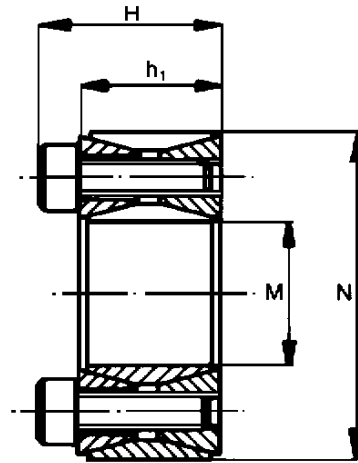
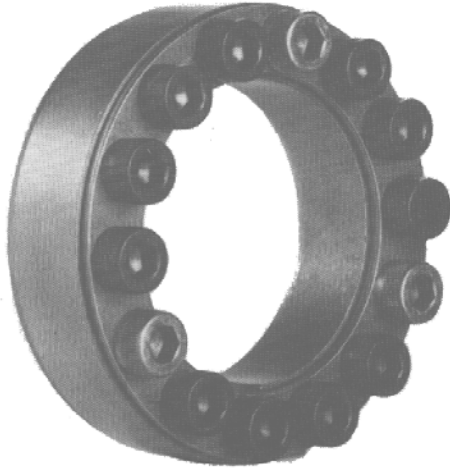

Code M x N mm	H mm	Screw Class 12.9		Transmitted Torque Nm	Axial Force Nm	Screw tightening Torque Nm
		No	Type			
20 x 47	27.5	8	M 6 X 18	280	27	14.7
22 x 47	27.5	8	M 6 X 18	314	27	14.7
24 x 50	27.5	9	M 6 X 18	314	27	14.7
25 x 50	27.5	9	M 6 X 18	383	30	14.7
28 x 55	27.5	10	M 6 X 18	481	33	14.7
30 x 55	27.5	10	M 6 X 18	519	33	14.7
32 x 60	27.5	12	M 6 X 18	550	39	14.7
35 x 60	27.5	12	M 6 X 18	716	39	14.7
38 x 65	27.5	14	M 6 X 18	880	45	14.7
40 x 65	27.5	14	M 6 X 18	931	45	14.7
45 x 75	33.5	12	M 8 X 22	1608	71	36
50 x 80	33.5	12	M 8 X 22	1775	70	36
55 x 85	33.5	14	M 8 X 22	2266	82	36
60 x 90	33.5	14	M 8 X 22	2364	81	36
65 x 95	33.5	16	M 8 X 22	3020	91	36
70 x 110	39.5	14	M 10 X 25	4560	129	71
75 x 115	39.5	14	M 10 X 25	4836	129	71
80 x 120	39.5	14	M 10 X 25	5120	129	71
85 x 125	39.5	16	M 10 X 25	6239	145	71
90 x 130	39.5	16	M 10 X 25	6219	144	71
95 x 135	39.5	18	M 10 X 25	7769	164	71
100 x 145	47	14	M 12 X 30	9447	188	125